

TIMBER TAKE OFF COURSE

By attending this workshop, participants will confidently be able to provide accurate estimates in a timely manner leading to increased customer satisfaction, with the service provided and repeat business.

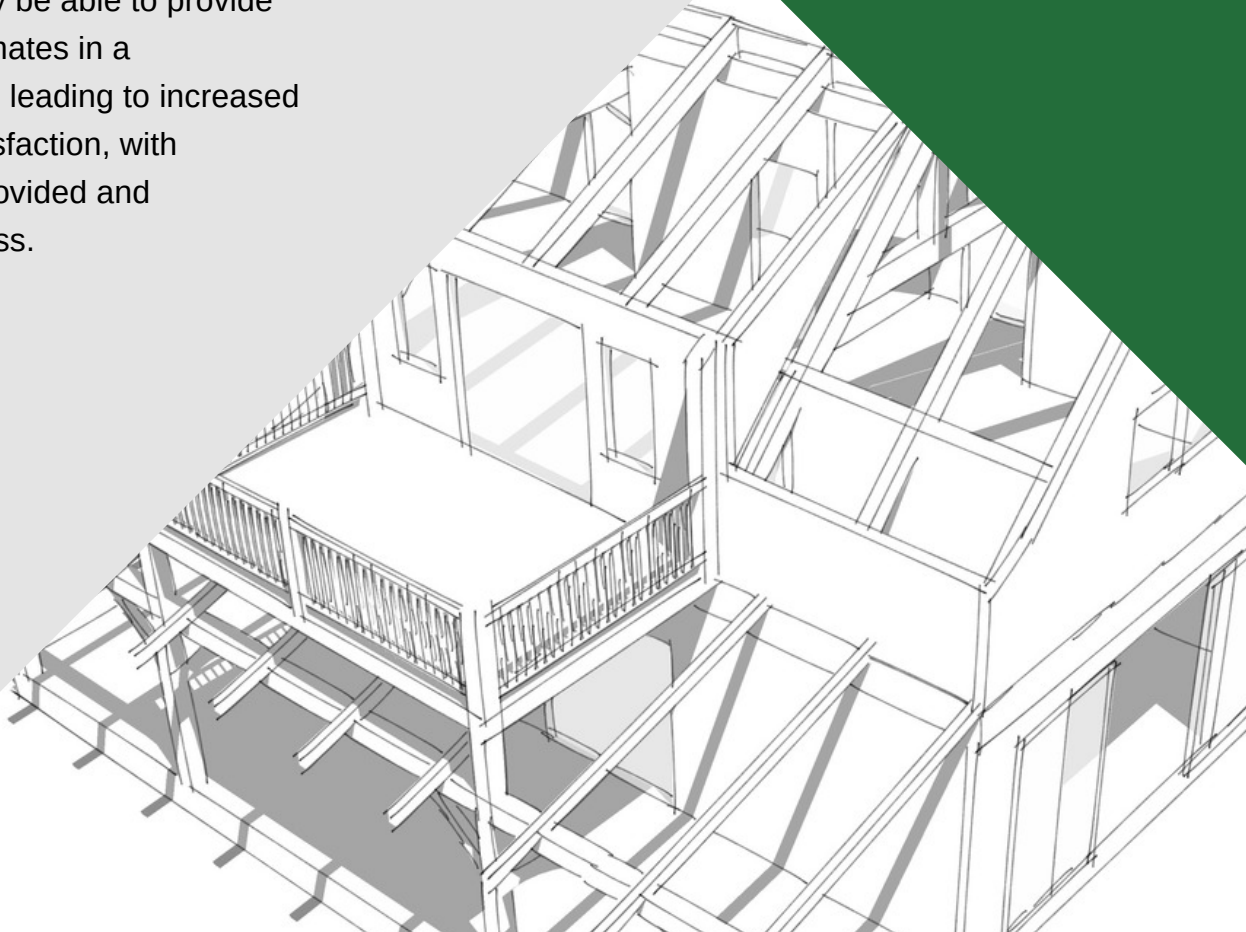

TABMA TRAINERS ARE LEADING INDUSTRY EXPERTS WITH EXTENSIVE EXPERIENCE IN THE INDUSTRY!

Timber merchants are frequently asked to interpret plans and sketches for customers in order to provide quotes. This course provides participants with the knowledge and skills required to provide effective estimation advice to clients based on simple construction drawings.

What you will learn:

- How to interpret sketches and drawings.
- How to accurately “take off” measurements and quantities from drawings.
- How to advise key considerations when advising customers.
- How to perform quantity and cost calculations.
- How to reduce errors at the design and quoting stage.
- How to maximise sales by identifying add-ons and ancillary items.

2 DAY COURSE ONLY \$650*

“Our people are more aware of how their job impacts on others in the business. This has led to people discovering even better ways of working together. TABMA trainers have relevant industry experience and can add real value to our participants.”

Neil Jones - Versace Timber



1300 693 483
info@tabmatraining.edu.au

*TABMA Members receive 10% discount.

*Hardware Australia Members receive 5% discount.